

# VIZCAYNE

## RESIDENCE 1

2 Bedroom, 2 Bath

Living Space 1044 sq. ft. (96.99 m<sup>2</sup>)  
 Balcony 98 sq. ft. (9.10 m<sup>2</sup>)  
 Total Living Area 1142 sq. ft. (106.09 m<sup>2</sup>)



Contact: Condoideas.com

Tel. (305) 428-2439

Fax. (305) 675-2779

Email: [Info@condoideas.com](mailto:Info@condoideas.com)

Web [www.condoideas.com](http://www.condoideas.com)

Condoideas.com is an independent service provider and is not affiliated with the developer

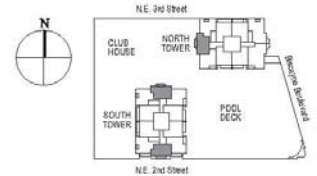

Unit Dimensions and Square Footages: There are two generally accepted methods of measuring the boundaries of such as residential condominiums. The first method is based on the description of the boundaries of the Unit, as set forth in Section 22 of the Declaration of Condominium, and generally only includes the space within the Unit (the "Engineering Method"). The other method, which is commonly used in sales brochures, generally measures the Unit to the outside finished surface of exterior walls and to the centerline of exterior opening walls, includes portions of the adjacent Common Elements (the "Architectural Method"). The estimated square footage of the Unit, as determined under the Architectural Method, will be greater than the estimated square footage as determined under the Engineering Method. The Architectural Method is generally used in sales materials and may be provided to illustrate a prospective buyer to compare the Unit with units in other condominium projects. But when the method of measurement