

VIZCAYNE

RESIDENCE 3 2 Bedroom, 2 Bath

Living Area	1195 sq. ft. (11.02 m ²)
Balcony	63 sq. ft. (5.85 m ²)
Total Living Area	1258 sq. ft. (116.87 m ²)



Contact: Condoideas.com
 Tel.(305) 428-2439
 Fax.(305) 675-2779
 Email. info@condoideas.com
 Web www.condoideas.com
 Condoideas.com is an independent service provider
 and is not affiliated with the developer

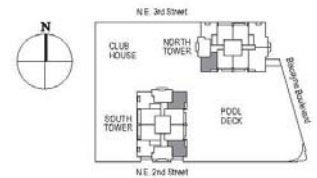

Unit Dimensions and Square Footage. There are two generally accepted methods of measuring the boundaries of such as residential condominiums. The first method is based on the description of the boundaries of the Unit, as set forth in Section 22 of the Declaration of Condominium, and generally only includes the space within the Unit (the "Engineering Method"). The other method, which is customarily used in sales brochures, generally measures the Unit to the outside finished surface of exterior walls and to the centerline of exterior bearing walls, include portions of the adjacent Common Elements (the "Architectural Method"). The estimated square footage of the Unit, as determined under the Architectural Method, will be greater than the estimated square footage as determined under the Engineering Method. The Architectural Method is generally used in sales materials and may be provided to show a prospective buyer to compare the Unit with units in other condominium projects. Both utilize the method of measurement.