

www.Condoideas.com

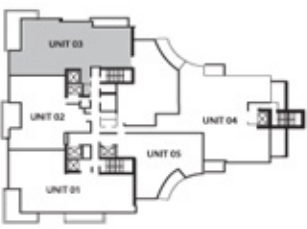

ENCLOSED AREA	2,304 SF	212 SM
BALCONY/TERRACE	410 SF	38 SM
TOTAL RESIDENCE	2,714 SF	250 SM

Not to scale. All dimensions are approximate and all floorplans and development plans are subject to change in accordance with the agreement for sale. Oral representations cannot be relied upon as correctly stating the representations of the developer. For correct representations, make reference to the documents required by section 718.503 Florida Statutes to be furnished by developer to buyer or lessee. Stated dimensions are measured to the exterior boundaries of exterior walls, corridor walls and to the centerline of interior demising walls and may vary from the description and definition of the "Unit" set forth in the Declaration.

Contact: Condoideas.com
 Tel. (305) 428-2439
 Fax. (305) 675-8327
 Email. info@condoideas.com
 Web. www.condoideas.com

